

IXCONNECT RECESSED CONNECTORS

ixconnect

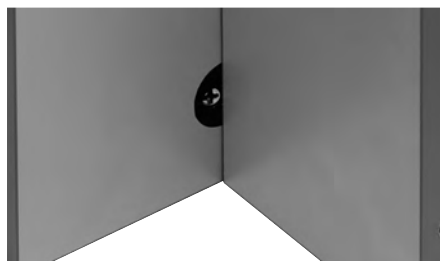

Recommended drilling for 19 mm board thickness

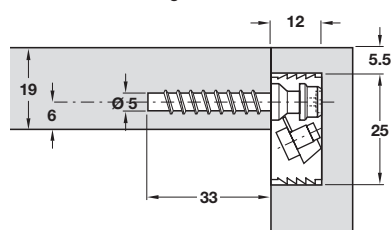

Recommended drilling for 16 mm board thickness

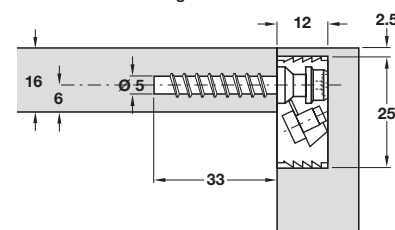

DC-25 cabinet connectors

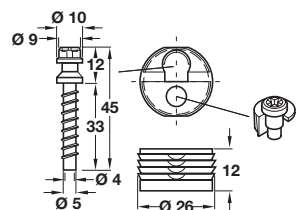

- > Consists of:
 - 1x housing for Ø 25 mm hole
 - 1x bolt
- > Plastic housing, zinc alloy bolt
- > Order qty: Multiples of 100 sets

Finish	Cat. No.
White	261.95.700
Brown	261.95.100

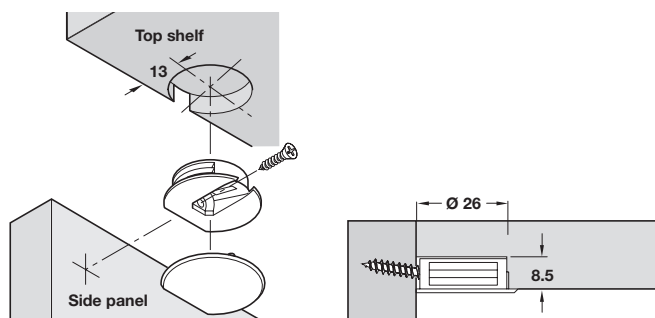

Recessed connecting fitting

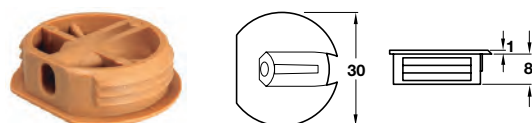

- > For light weight structures
- > Press fit in housing recess Ø 26 mm
- > Plastic
- > Order qty: Multiples of 100 pcs

Finish	Cat. No.
Beige	262.43.489

Cover cap

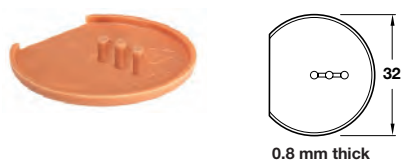

- > For recessed connecting fitting 262.43.489
- > Plastic
- > Order qty: Multiples of 100 pcs

Colour	Cat. No.
White	262.43.710
Beige	262.43.416