

CASTORS WITH Ø 30 MM WHEELS

Swivel castor, special use, Ø 30 mm wheel, plate fixing

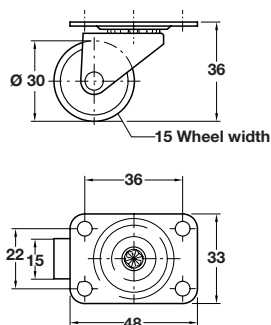

- > With 48 x 33 mm mounting plate
- > Galvanized steel housing, black plastic wheel
- > Order qty: 1 pc



Wheel Ø	Load capacity	Without brake
Ø 30 mm	15 kg	662.03.852

Twin wheel swivel castor, hooded, Ø 30 mm wheels, press fit

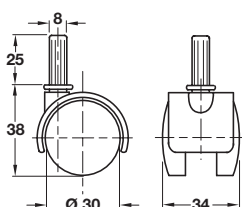

- > With Ø 8 x 25 mm dowel
- > Press fit, no additional T-nut or bush required
- > Suitable for use on soft floor coverings such as carpet
- > Matt black plastic
- > Order qty: 1 pc

Wheel Ø	Load capacity	Without brake
Ø 30 mm	25 kg	660.68.312

Twin wheel swivel castor, hooded, Ø 30 mm wheels, plate fixing

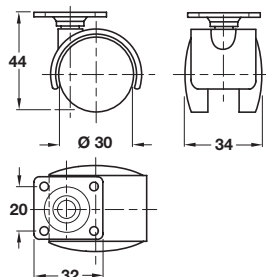

- > With 32 x 32 mm mounting plate
- > 20 x 20 mm screw hole distances
- > Matt black plastic
- > Order qty: 1 pc



Wheel Ø	Load capacity	Without brake
Ø 30 mm	25 kg	660.62.312